

1. Remove all contents from cabinet.
2. Carefully rotate cabinet on its back and then onto its top, all while on a soft surface to prevent damage. To prevent damage, do not slide cabinet while on back or top.
3. **For Outrigger Casters**, fasten each caster assembly with three hex screws into holes shown in red. Ensure that the casters extend out to the front and rear of the cabinet with locking casters in the front of the unit.

For Standard Casters, fasten each caster with four hex screws into holes shown in green. Locking casters should be in the front of the unit.

4. Carefully rotate cabinet on its back on a soft surface to prevent damage. Do not slide cabinet while on its back to prevent damage. Rotate cabinet upright onto casters.

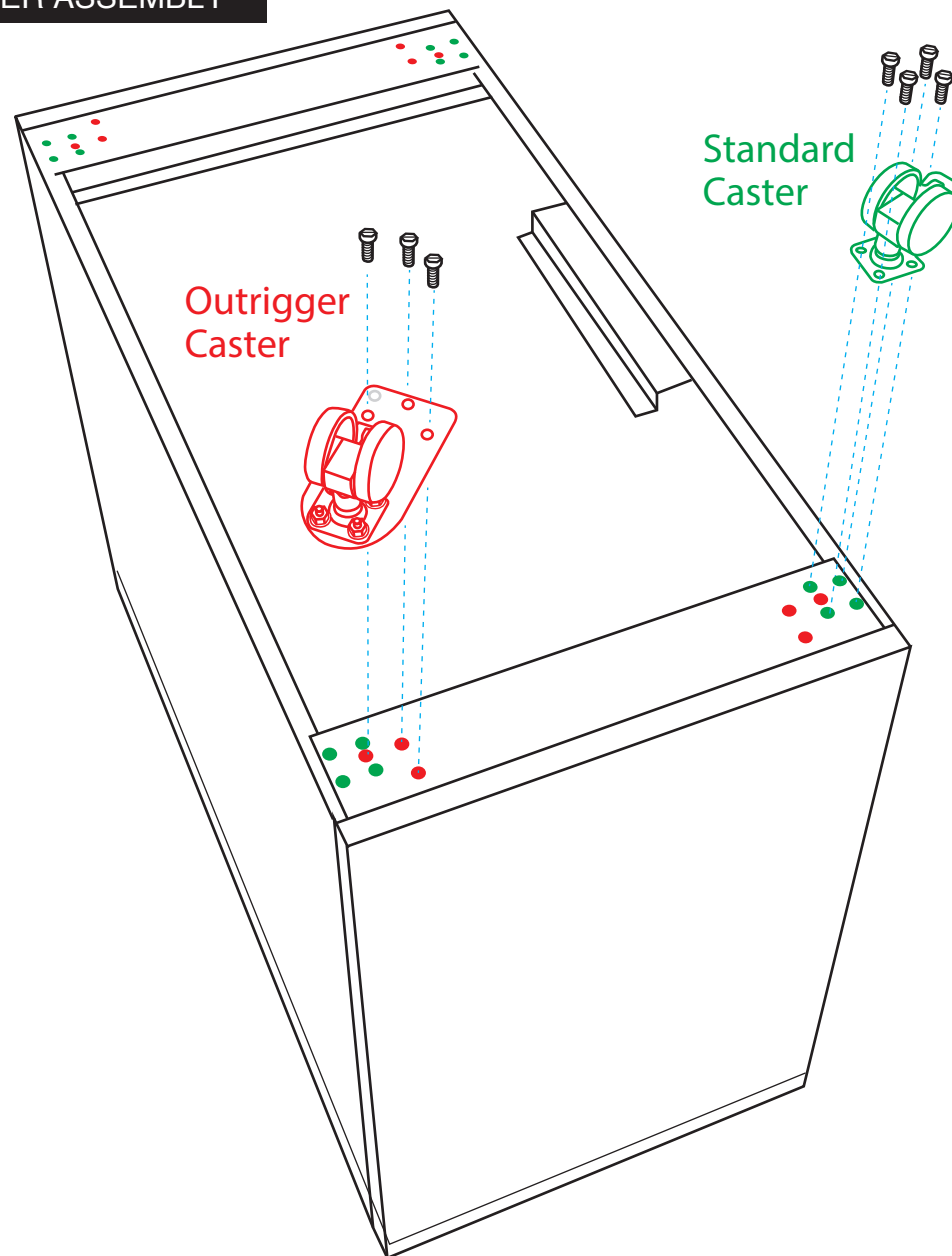

Tool(s) needed:

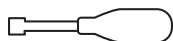

5/16" Nut Driver

Hardware included:



(12 or 16) 10-32 x 1/2"
Hex screws