

Ojmar Combi Pro Helpful links



[Quick Start Guide](#)



[Product Info](#)



[Installation
Instructions](#)



[How To
Operate Video](#)



[Public To
Private Video](#)

How to set up public or reset mode operation:

In this mode the lock can be reset by the user. Upon vacating the locker, a new user can set a new code.

1. Ensure that the mode key set screw on the rear of the lock is turned to the “R” position. **Fig A1**
2. Make sure the lock is turned to the open position. **Fig B**
3. Turn the wheels to the desired 4-digit code. Remember the code!
4. Close the door and turn the lock to the closed position. **Fig C**
5. Scramble the code by randomly turning the code wheels.
6. This will secure the lock and prevent others from opening the door.
7. To open, enter the personal code on the code wheels that was used to lock the door.
8. Turn the lock dial to the open position and open your door.

How to set up private mode operation:

In this mode the lock code is fixed and the same code will be used to open the lock each time.

1. Ensure that the mode key set screw on the rear of the lock is turned to the “R” position. **Fig A1**
2. Turn the lock to the open position. **Fig B**
3. Turn the wheels to the desired 4-digit code. Remember the code!
4. Turn the lock 90 degrees to the closed position.
5. Now turn the mode key set screw on the rear of the lock to position “F”. **Fig A2**
6. The lock is now ready to be used in private mode with the same code every time.
7. To open, enter the personal code on the code wheels that was used to lock the door.
8. Turn the lock dial to the open position and open your door.

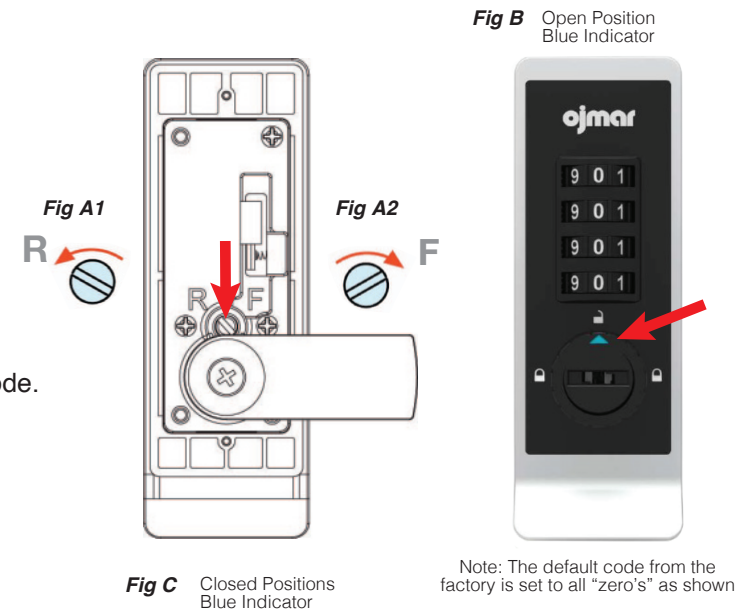

Fig C Closed Positions
Blue Indicator



Right Hinge Lock

Left Hinge Lock