



**GREAT
OPENINGS**

Speed Support Performance



**THE
SHINGO
PRIZE**
FOR OPERATIONAL
EXCELLENCE



COLOR IT EASY!

TRACE™ *collection*

TOWERS

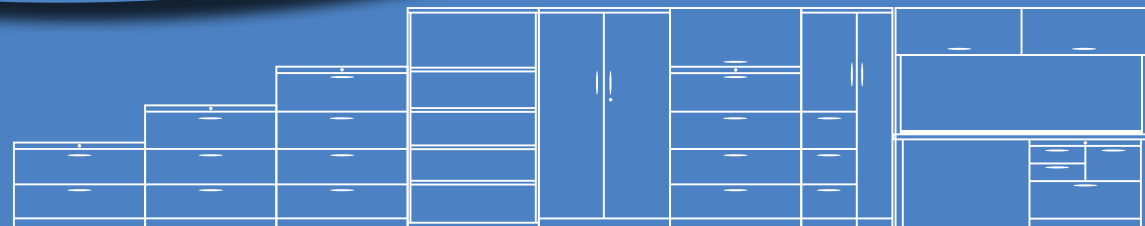

TRACE TOWERS

All TRACE™ towers feature horizontal lines & full width fronts consistent with all other TRACE™ products.

Great Openings is a proud recipient of the National Shingo Prize for operational excellence.

All Great Openings products include a lifetime warranty and meet ANSI-BIFMA standards for durability and safety.

Features:

- All handed towers are available with both left and right options.
- All wardrobe towers and modular towers are 23 1/2" wide by 23 1/2" deep. Height options are shown at right.
- All cupboard and bookcase units (those without wardrobe closets) are 15 1/4" wide by 23 1/2" deep. Height options are shown at right.
- V-Ped towers are 15 1/4" wide by 27 7/8" deep. Height options are shown at right.
- Steel frame construction is welded and channels are formed in key areas for strength.
- Top, back, side, and center panels are 21 gauge metal. Inner channels and shelves are 18 gauge. Fronts are 20-22 gauge.
- Some towers have drawer front limitations; see our price book for details.
- Full extension steel ball-bearing slides on all drawers.
- Tower drawers include a safety interlock that allows only one drawer to open at a time.
- All cabinets come standard with UM locks which are master-keyed and core removable.
- Other key series include SL, K, and LL. Key alike service is available.
- Freestanding units include leveling glides that allow for 7/8" to 1 5/8" adjustment, depending on the cabinet style.
- Mobile units available with either 75mm black (2 locking, 2 non-locking) or translucent (non-locking) casters.

Surface Materials:

Finishes - All products are available in 55 standard colors, with an additional 130+ "Industry Favorite" colors also offered as standard. We also welcome custom colors.

Accessories:

- Solid or translucent dome top available for 23.5" x 23.5" towers.
- Magnetic shelf dividers.
- 6" drawer dividers, 12" drawer dividers that also allow for side-to-side filing, and pencil trays.
- Laminate fronts available for cupboard wardrobe tower.
- Work surface support bracket available for bookcase wardrobe tower and bookcase tower.

TRACE™ Cupboard Wardrobe Tower (Freestanding & Mobile)

Coat closet with side-to-side rod. Hinged-door cupboard with adjustable shelves and pedestal drawers all lock with a single key.

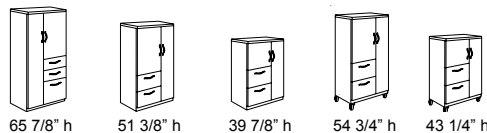

A: Full Pull

B: S-9000

TRACE™ Cupboard Tower

Single lock captures cupboard and drawers. Hinged-door cupboard with adjustable shelves. Cupboard door is radiused or squared to match drawer fronts. Will not accommodate the work surface support bracket.

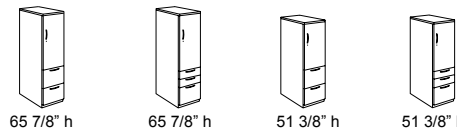

C: Radiused Front Droop Loop

D: Radiused Front Recessed Pull

F: Square Front Recessed Pull

TRACE™ V-Ped Tower

Features all GO front and lock styles. Functions as a vertical file and single lock captures all drawers. Safety interlock is included, allowing only one drawer to open at a time. Includes standard pedestal drawer with full extension slides. Finish height of 5 drawer v-ped is **not** consistent with TRACE™ products.

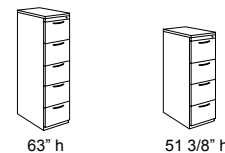

G: Radiused Front Straight Loop

I: Radiused Front "HW" Pull

TRACE™ Bookcase Wardrobe Tower

Featuring adjustable shelves in side-access bookcase and coat closet with two-pronged coat hook. Two locks are keyed-alike. Work surface support bracket is sold separately.

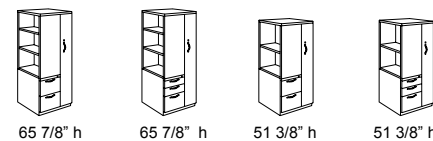

N: Radiused Front Satin Nickel Pull

S: Square Front Satin Nickel Pull

TRACE™ Bookcase Tower

Pedestal drawer storage with side-access bookcase. Single lock captures all drawers. 65 7/8" tower: two adjustable shelves, 51 3/8" tower: one adjustable shelf. Bookcase edge is radiused or squared to match drawer fronts. Work surface support bracket is sold separately.

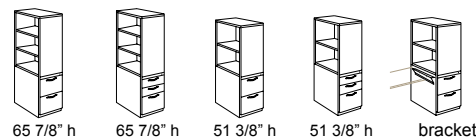

P: Square Front "P" Pull

K: Square Front Camber Pull (upcharge applies)

TRACE™ Modular Tower (Freestanding & Mobile)

Full depth lateral drawers below, with double door storage and adjustable shelves on top. Two locks are keyed-alike. Limited front styles available; see price book for details.

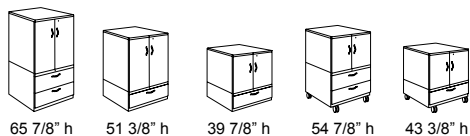

R: Square Front Chunky Pull (upcharge applies)

TRACE™ Modular Tower with Aluminum Doors (Freestanding & Mobile)

Features are identical to modular towers described above. Anodized aluminum door frame is 1 3/4" wide. Frosted acrylic insert is 1/8" thick. Cupboard doors do not lock, single lock captures all drawers.

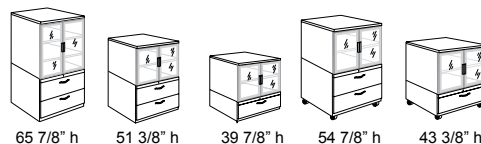

W: Square Front Twist Pull (upcharge applies)

Wardrobe Dome Top

Metal dome fits any 23 1/2" x 23 1/2" tower. Factory installed. Adds 5" to finish height of tower. Also available with translucent acrylic. Because the dome top carries a square front vertical edge, it is not recommended for use on cabinets that include radiused door and drawer fronts.

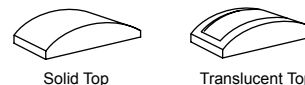

N & S fronts are also available with black pull

Selected products also available with laminate fronts



902 E. Fourth Street • Ludington, MI 49431
Ph. 888-712-8582 Fax 231-843-6373
www.greatopenings.com

